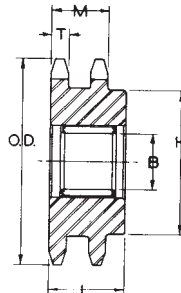
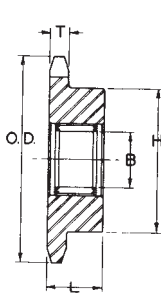

TABLE No. 1

### V-BELT SHEAVE IDLERS

PART No.	SHAFT LENGTH*	BELT SIZE	DIMENSIONS							WT. Lbs.	RADIAL LOAD CAPACITY IN POUNDS BASED ON 2500 HOURS AVERAGE LIFE AT RPM SHOWN ■							
			O.D.	B	H	F	L	P	C		100	500	1000	1500	2000	2500	3000	3500
NOK17	1 1/2"	3L	1.92"	1/2"	1 1/2"	1/2"	3/4"	1/4"	0	.1	665	406	331	294	269	250	237	226
NAK25	1 1/2"	4L or A	2.50	1/2	1 9/16	2 1/32	3/4	1/4	5/32"	.3	665	406	331	294	269	250	237	226
NAK30	1 1/2"	4L or A	3.05	1/2	1 9/16	2 1/32	3/4	1/4	5/32"	.5	665	406	331	294	269	250	237	226
NAK41	2 1/8"	4L or A	3.95	1	1 7/8	3/4	1	5/16	1/16	1.0	2174	1327	1083	961	880	820	772	741
NBK40	2 1/8"	5L or B	3.96	1	1 7/8	7/8	1	1/4	1/8	1.1	2174	1327	1083	961	880	820	772	741
NBK52	2 1/8"	5L or B	4.96	1	1 7/8	7/8	1	1/4	1/8	1.6	2174	1327	1083	961	880	820	772	741



**HARDENED  
TEETH**



TABLE No. 2

### SPROCKET IDLERS WITH HARDENED TEETH

PART No.	SHAFT LENGTH*	CHAIN SIZE	No. TEETH	DIMENSIONS						WT. Lbs.	RADIAL LOAD CAPACITY IN POUNDS BASED ON 2500 HOURS AVERAGE LIFE AT RPM SHOWN ■							
				O.D.	T	M	H	L	B		100	500	1000	1500	2000	2500	3000	3500
<b>For ANSI Roller Chain - Dimensions in Inches</b>																		
HN25B19	1 1/2"	25	19	1.65"	.110"	-	1 7/32"	3/4"	1/2"	.1	665	406	331	294	269	250	237	226
HN35B13	1 1/2"	35	13	1.75	.168	-	1 5/32	3/4	1/2	.1	665	406	331	294	269	250	237	226
HN35B19	2 1/8"	35	19	2.47	.168	-	1 13/16	1	1	.3	2174	1327	1083	961	880	820	772	741
HN41B19	2 1/8"	41	19	3.28	.227	-	2 7/16	1	1	.9	2174	1327	1083	961	880	820	-	-
HN40B19	2 1/8"	40	19	3.28	.284	-	2 7/16	1	1	1.0	2174	1327	1083	961	880	820	-	-
HN50B17	2 1/8"	50	17	3.72	.343	-	2 5/8	1	1	1.3	2174	1327	1083	961	880	820	-	-
HN60B17	2 1/8"	60	17	4.46	.459	-	2 5/8	1	1	1.9	2174	1327	1083	961	880	-	-	-
HN80B13	2 1/8"	80	13	4.66	.575	-	2 5/8	1 1/4	1	2.6	2174	1327	1083	961	880	-	-	-
HN100B11	4	100	11	5.01	.692	-	2 31/32	1 7/8	1 1/2	3.7	5884	3592	2930	2602	-	-	-	-
HN120B11	4	120	11	6.01	.924	-	3 11/16	2	1 1/2	7.1	5884	3592	2930	2602	-	-	-	-
HN140B11	4	140	11	7.01	.924	-	4 3/16	2 1/4	1 1/2	10.8	5884	3592	2930	2602	-	-	-	-
HND35B19	2 1/8"	35-2	19	2.47	.162	.561"	1 13/16	1	1	.4	2174	1327	1083	961	880	820	772	741
HND40B19	2 1/8"	40-2	19	3.28	.275	.841	2 7/16	1 1/4	1	1.6	2927	1787	1458	1295	1185	1104	-	-
HND50B17	2 1/8"	50-2	17	3.72	.332	1.045	2 5/8	1 3/8	1	2.0	2927	1787	1458	1295	1185	-	-	-
HND60B17	3 1/8"	60-2	17	4.46	.444	1.341	2 5/8	1 3/4	1	4.0	4348	2654	2166	1922	1760	-	-	-
HND80B13	3 1/8"	80-2	13	4.66	.557	1.710	2 5/8	2 1/4	1	5.2	4348	2654	2166	1922	-	-	-	-
HND100B11	4	100-2	11	5.01	.669	2.077	2 21/32	2 7/8	1 1/2	6.1	5884	3592	2930	2602	-	-	-	-

\*For use with Drive Tighteners shown on pages I-2 and I-3 and I-4 with shaft lengths indicated.

■ See page I-8 for factors to use for Average Life of more or less than 2500 hours.

All Browning® Stock Idlers furnished with needle bearings have retainers that insure minimum internal friction and wear by separating the needle rollers. These bearings are inset approximately 1/8" on either end of the Idler hubs to form a grease cavity.