

PRODUCT INFORMATION PACKET



Model No: 100141.00

Catalog No: 100141.00

General Purpose Motor, 0.33 HP, 3 Ph, 60 Hz, 575 V, 1800 RPM, S56 Frame, DP

Regal and Leeson are trademarks of Regal Rexnord Corporation or one of its affiliated companies.
©2022 Regal Rexnord Corporation, All Rights Reserved. MC017097E





Nameplate Specifications

Output HP	0.33 Hp	Output KW	0.25 kW
Frequency	60 Hz	Voltage	575 V
Current	0.64 A	Speed	1725 rpm
Service Factor	1.35	Phase	3
Efficiency	64.3 %	Power Factor	61.1
Duty	Continuous	Insulation Class	B
Design Code	B	KVA Code	M
Frame	S56	Enclosure	Drip Proof
Thermal Protection	No Protection	Ambient Temperature	40 °C
Drive End Bearing Size	6203	Opp Drive End Bearing Size	6203
UL	Recognized	CSA	Y
CE	N	IP Code	22
Number of Speeds	1		

Technical Specifications

Electrical Type	Squirrel Cage Induction Run	Starting Method	Across The Line
Poles	4	Rotation	Reversible
Resistance Main	0 Ohms	Mounting	Rigid Base
Motor Orientation	Horizontal	Drive End Bearing	Ball
Opp Drive End Bearing	Ball	Frame Material	Rolled Steel
Shaft Type	NEMA 56	Overall Length	8.99 in
Shaft Diameter	0.625 in	Shaft Extension	1.94 in
Assembly/Box Mounting	F1 ONLY		
Connection Drawing	005102.01	Outline Drawing	031620-550

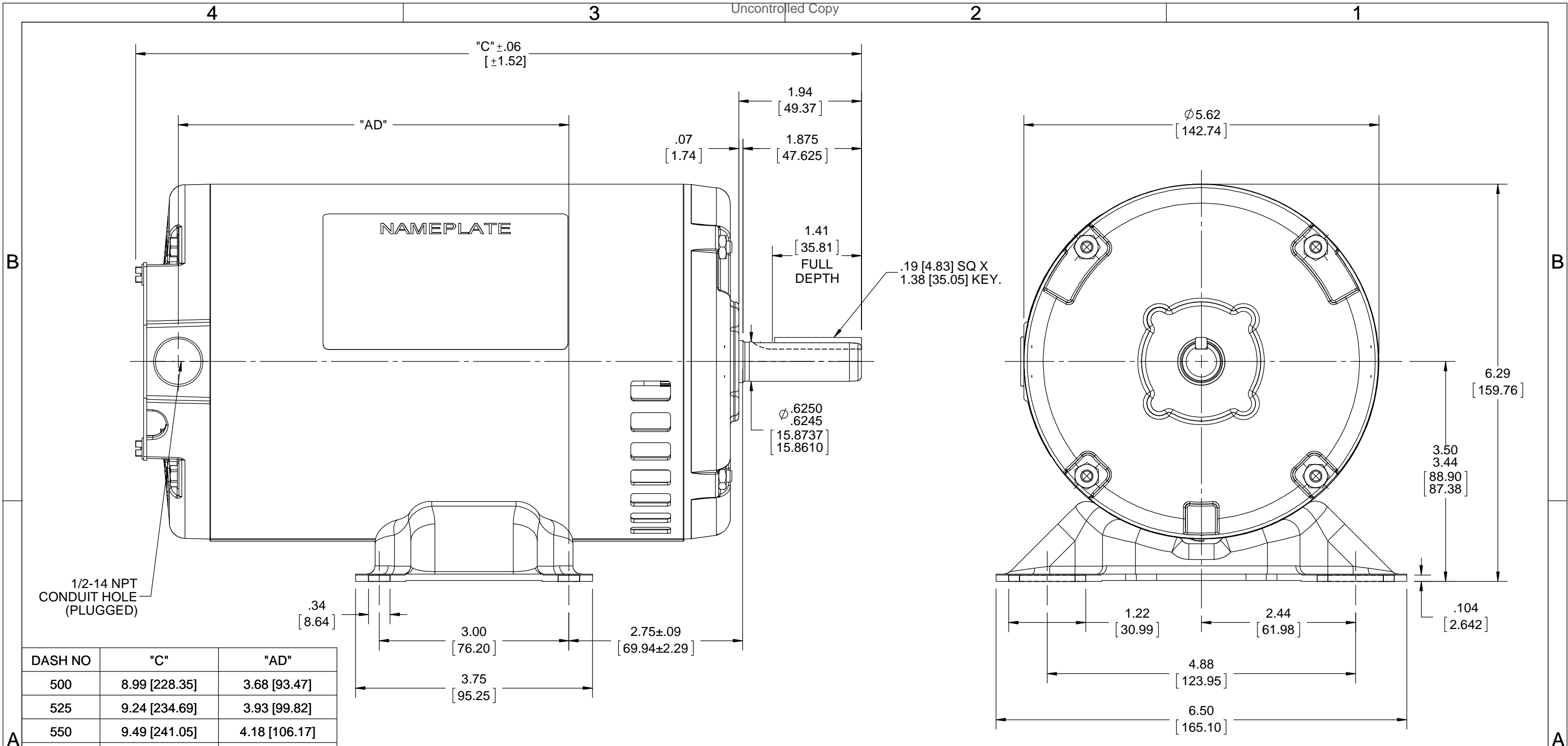

DASH NO	"C"	"AD"
500	8.99 [228.35]	3.68 [93.47]
525	9.24 [234.69]	3.93 [99.82]
550	9.49 [241.05]	4.18 [106.17]
575	9.74 [247.39]	4.43 [112.52]
600	9.99 [253.75]	4.68 [118.87]
625	10.24 [260.09]	4.93 [125.22]
650	10.49 [266.45]	5.18 [131.57]
675	10.74 [272.79]	5.43 [137.92]
700	10.99 [279.15]	5.68 [144.27]
725	11.24 [285.49]	5.93 [150.97]
750	11.49 [291.85]	6.18 [156.97]
775	11.74 [298.19]	6.43 [163.32]
800	11.99 [304.55]	6.68 [169.67]

DRAWING REVISION E	REVISION BY A SUPPANAVAR	DATE 09/18/2018
ECO ECO-0154532	APPROVED BY JD	DATE 10/11/2018
ECO DESCRIPTION OUTLINE CONVERSION PROJECT COPYRIGHT REGAL BELOIT AMERICA, INC. ALL RIGHTS RESERVED. PROPRIETARY AND CONFIDENTIAL INFORMATION - THIS DOCUMENT IS THE PROPERTY OF REGAL BELOIT AMERICA, INC. ("OWNER") AND CONTAINS OWNER'S PROPRIETARY INFORMATION. ANY PERSON, CORPORATION OR OTHER FIRM RECEIVING IT IS DEEMED, BY RECEIVING IT, TO AGREE THAT IT, AND/OR ANY PART OF IT, SHALL NOT BE DISCLOSED TO ANY PERSON, CORPORATION OR OTHER ENTITY, DUPLICATED, AND/OR USED, EXCEPT AS EXPRESSLY APPROVED IN WRITING IN ADVANCE BY OWNER. THIS DOCUMENT SHALL BE RETURNED TO OWNER UPON REQUEST. IT MAY BE SUBJECT TO CERTAIN RESTRICTIONS UNDER APPLICABLE EXPORT CONTROL LAWS AND REGULATIONS.		

TOLERANCES UNLESS OTHERWISE SPECIFIED:			
DEC.	INCH	mm	ANGLE
.X	±0.1	[±2.5]	±7° 30"
.XX	±0.03	[±0.76]	
.XXX	±0.005	[±0.127]	
.XXXX	±0.0005	[±0.0127]	
REMOVE BURRS & BREAK SHARP EDGES: .003/.015 [0.076/.381] X 45° CORNER FILLETS: R.02 [0.51] MACHINED SURFACES: 200 INCH/mm 5.1 mm SHOWN IN [BRACKETS]			

DRAWN BY PG	REGAL™ Regal Beloit America, Inc.	
DATE 5/24/01	DESCRIPTION OUTLINE RIGID MOUNT-DRIP PROOF 3 PHASE	
APPROVED BY	MATERIAL	PROCESS/FINISH
DATE	DRAWING NUMBER 031620	
REFERENCE 031067	SIZE B	SHEET 1 OF 1
THIRD ANGLE PROJECTION		

005102-01

VIEW FROM OUTSIDE OF MOTOR AT SWITCH END.

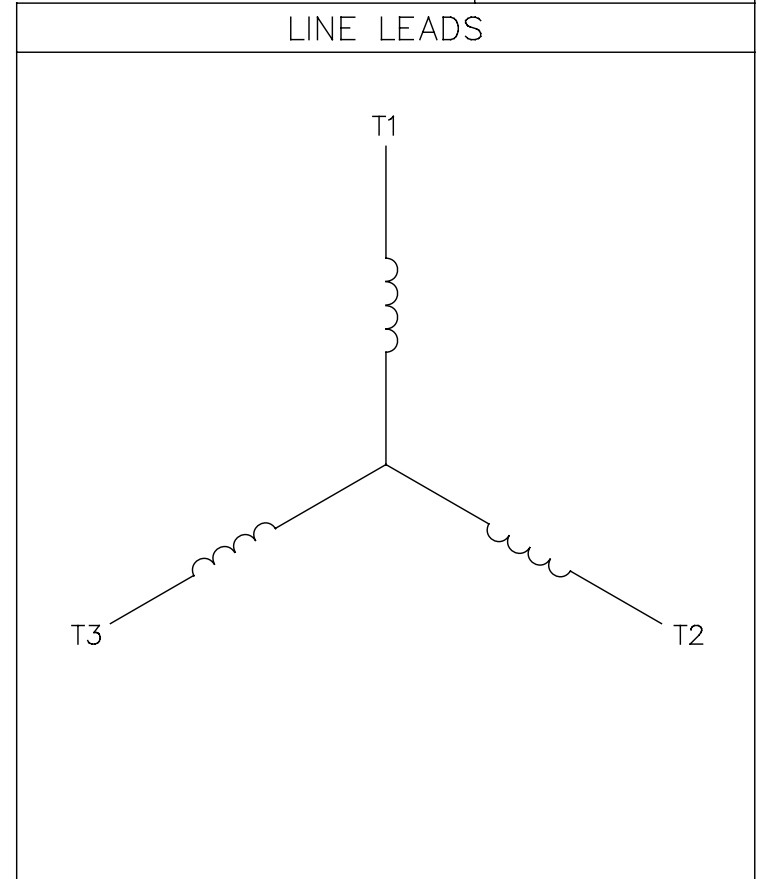
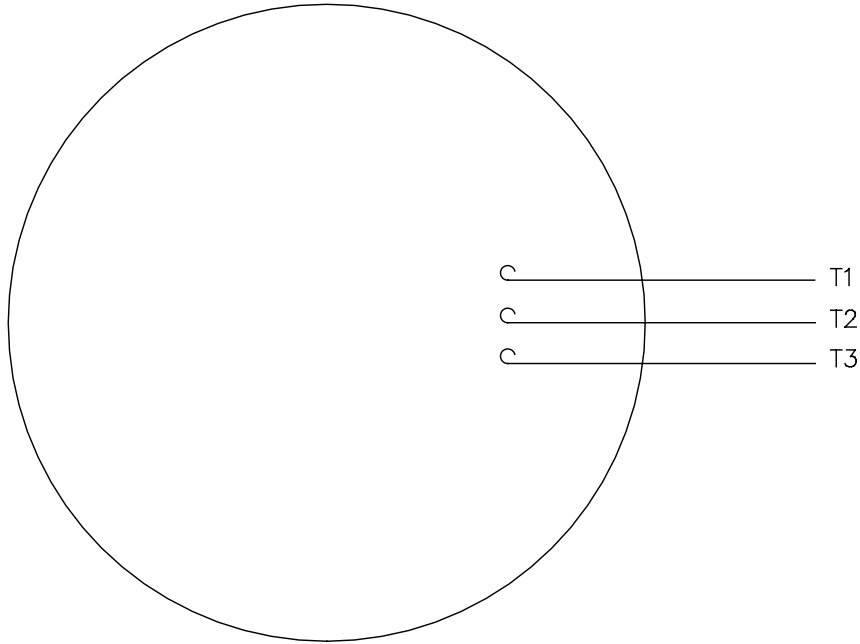

CONNECT LEADS AS FOLLOWS
FOR FOUR CONDUCTOR CORD ()

CORD	L1 (RED)	L2 (WHITE)	L3 (BLACK)	(GREEN)
MOTOR	T1	T2	T3	GROUND

				TOLERANCES UNLESS SPECIFIED		Regal Beloit America, Inc.		DRAWN JRW 9/11/75			
				DEC.	INCHES			CHK			
				.X	±.1			APPD JCW 9/11/75			
08	UPDATED TO REGAL LOGO	SAJ 06/26/15	AJY	.XX	±.01	TITLE EXTERNAL WIRING DIAGRAM TYPE "T" W/O PROTECTOR		SCALE 1=1			
07	UPDATED TO CURRENT STANDARDS	DBT 5/30/97		.XXX	±.005			REF W-T6343-6			
06	REDRAWN ON CAD; ADDED DECAL NUMBER	SAW 1/24/95		.XXXX	±.0005			FMF 6T17FB7			
NO.	REVISION	BY & DATE	CHK	ANG	±1/2"	FINISH		PREV			
THIS DRAWING IN DESIGN AND DETAIL IS OUR PROPERTY AND MUST NOT BE USED EXCEPT IN CONNECTION WITH OUR WORK ALL RIGHTS OF DESIGN AND INVENTION ARE RESERVED THIS IS AN ELECTRONICALLY GENERATED DOCUMENT - DO NOT SCALE THIS PRINT				RFP	5/1/02	CAD FILE 00510201		SIZE	DRAWING NO.		REV.
				DIST	BRF-NLV		A	005102-01		08	