

PRODUCT INFORMATION PACKET



Model No: 101405.00
Catalog No: 101405.00
Fan and Blower Motor, 0.33 HP, 1 Ph, 60 Hz, 115 V, 1800 RPM, 48 Frame, DP



Regal and Leeson are trademarks of Regal Rexnord Corporation or one of its affiliated companies.

©2023 Regal Rexnord Corporation, All Rights Reserved. MC017097E





Nameplate Specifications

Output HP	0.33 Hp	Output KW	0.25 kW
Frequency	60 Hz	Voltage	115 V
Current	3.2 A	Speed	1725 rpm
Service Factor	1.35	Phase	1
Efficiency	75 %	Power Factor	94
Duty	Continuous	Insulation Class	F
Design Code	NO DESIGN CODE	KVA Code	K
Frame	48	Enclosure	Drip Proof
Thermal Protection	Automatic	Ambient Temperature	40 °C
Drive End Bearing Size	6203	Opp Drive End Bearing Size	6203
UL	Recognized	CSA	Y
CE	N	IP Code	22
Number of Speeds	1		

Technical Specifications

Electrical Type	Capacitor Start Capacitor Run	Starting Method	Across The Line
Poles	4	Rotation	Selective Counterclockwise
Resistance Main	2.24 Ohms	Mounting	Resilient Base
Motor Orientation	Horizontal	Drive End Bearing	Ball
Opp Drive End Bearing	Ball	Frame Material	Rolled Steel
Shaft Type	NEMA 48	Overall Length	10.39 in
Frame Length	6.00 in	Shaft Diameter	0.500 in
Shaft Extension	1.5 in	Assembly/Box Mounting	F1 ONLY
Connection Drawing	005326.02	Outline Drawing	031760-600

This is an uncontrolled document once printed or downloaded and is subject to change without notice. Date Created:03/15/2023

031760

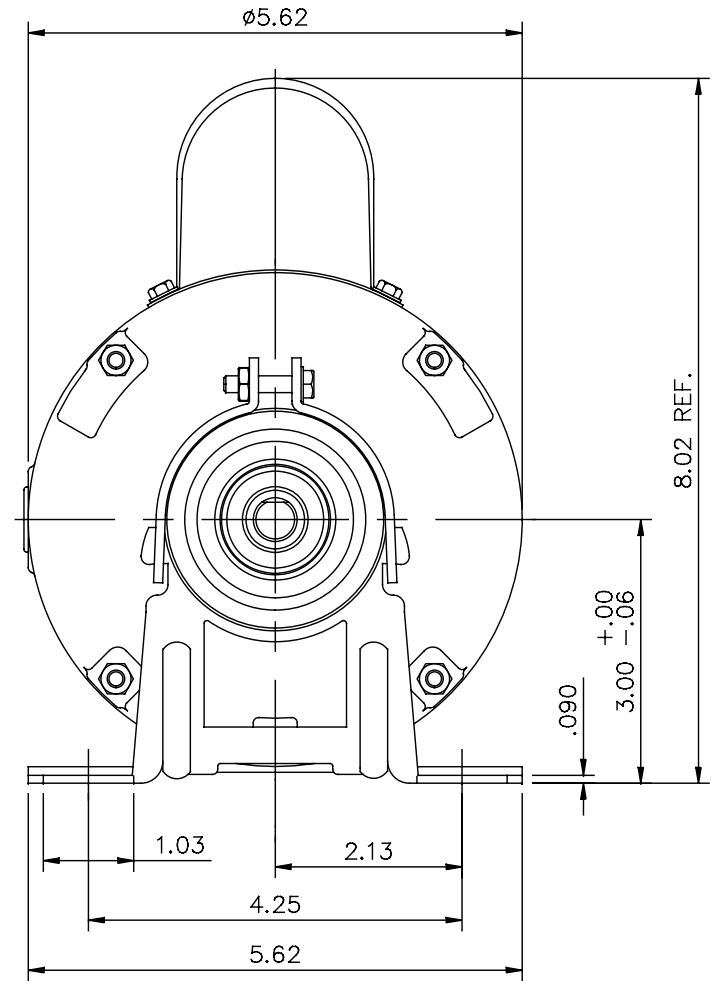
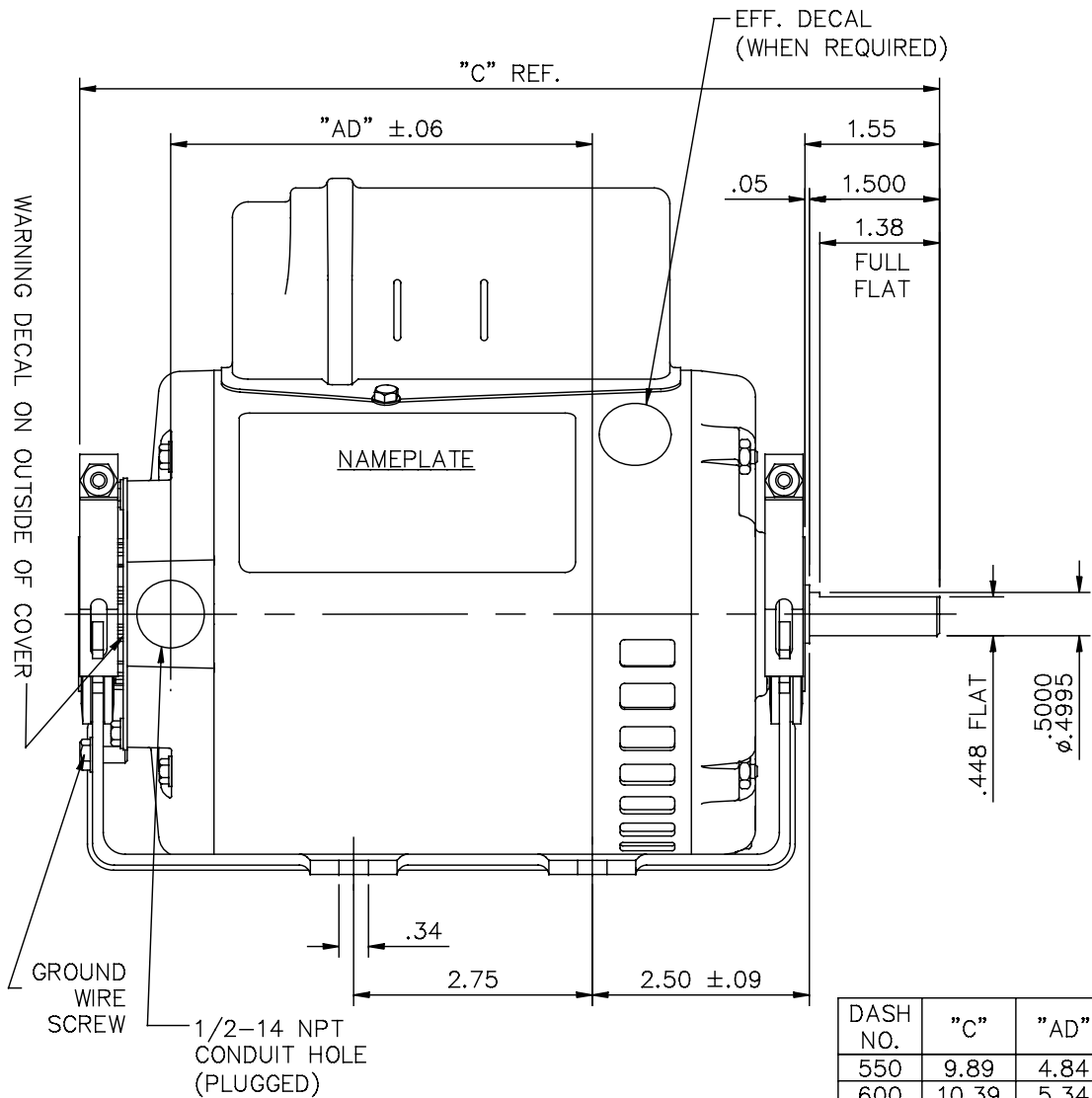

DASH NO.	"C"	"AD"
550	9.89	4.84
600	10.39	5.34
650	10.89	5.84

				TOLERANCES UNLESS SPECIFIED		REGAL-BELOIT <i>Motor Technologies Group</i>		DRAWN PG 2/20/04		
				DEC.	INCHES	TITLE OUTLINE - 48 FRAME RESILIENT MOUNT - DRIP PROOF		CHK		
				.X	±.1			APPD		
				.XX	±.03			SCALE 1=2		
				.XXX	±.005			REF 030761		
				.XXXX	±.0005	MAT'L 1 PHASE		FMF 101405.00		
				ANG	±1/2°	FINISH STANDARD		PREV		
01	UPDATED WITH OUTER COVER, GROUND SECREW AND EFF DECALS	SL	10/20/15	JD		CAD FILE 031760		SIZE A	DRAWING NO. 031760	REV.
NO.	REVISION	BY & DATE	CHK	ANG						
THIS DRAWING IN DESIGN AND DETAIL IS OUR PROPERTY AND MUST NOT BE USED EXCEPT IN CONNECTION WITH OUR WORK ALL RIGHTS OF DESIGN AND INVENTION ARE RESERVED THIS IS AN ELECTRONICALLY GENERATED DOCUMENT - DO NOT SCALE THIS PRINT						RFP				
						DIST				

VIEW FROM OUTSIDE OF MOTOR AT SWITCH END.

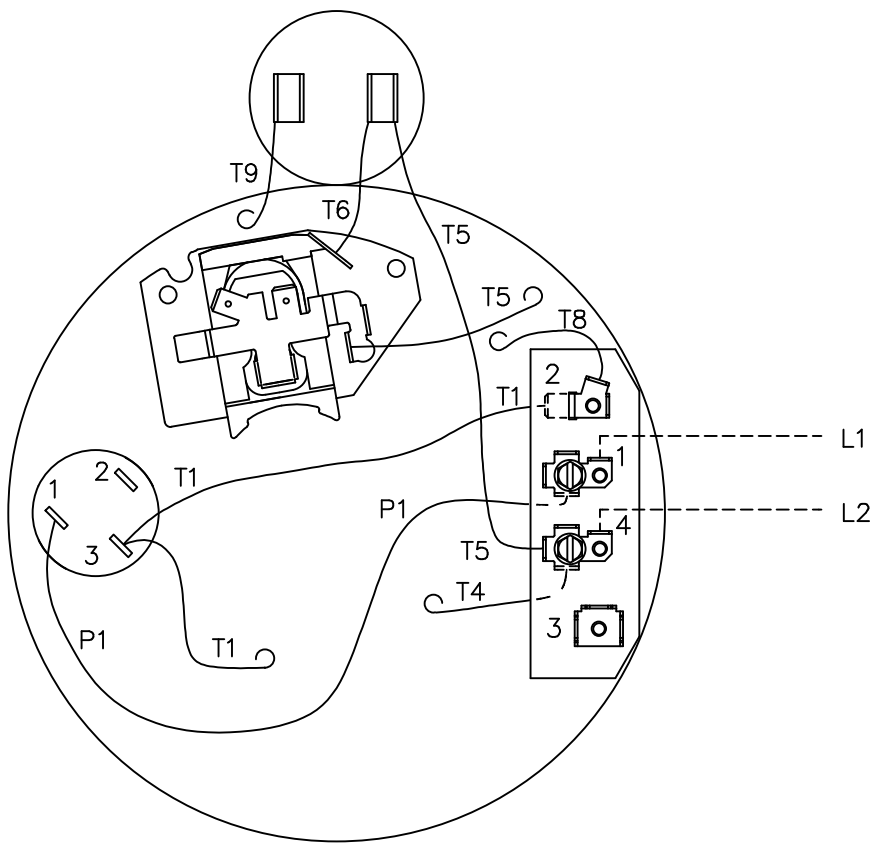

P1, T1, T4 TO GO TO
BACK SIDE OF TERMINAL BOARD

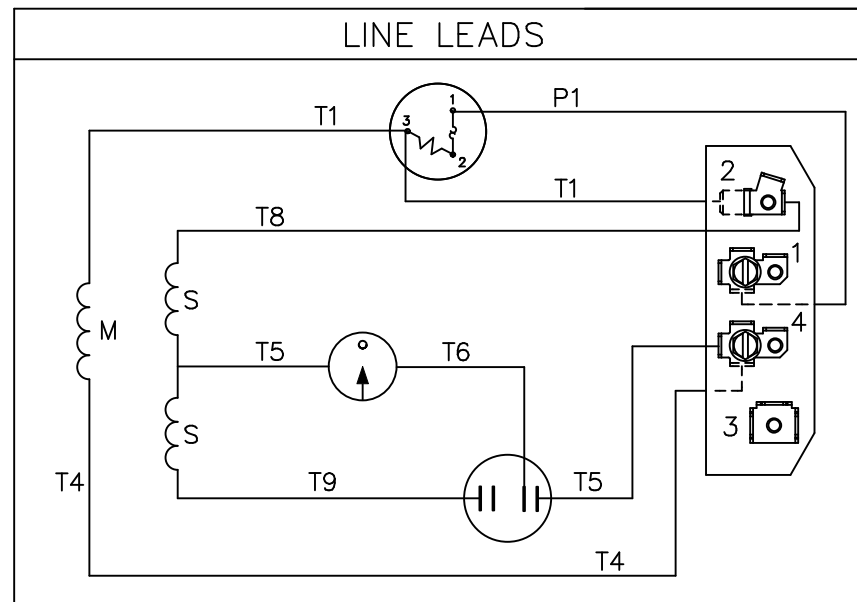

C.C.W.L.E. ROTATION

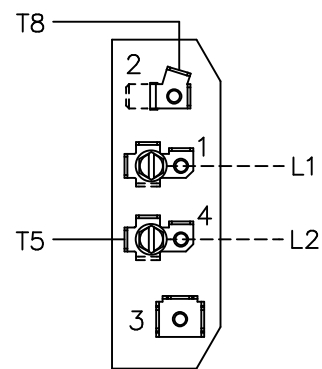

C.W.L.E. ROTATION

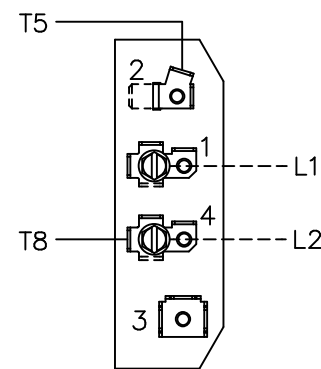

		TOLERANCES UNLESS SPECIFIED	
		DEC.	INCHES
		.X	±.1
		.XX	±.01
		.XXX	±.005
		.XXXX	±.0005
NO.	REVISION	BY & DATE	CHK

	ELECTRIC MOTORS GEARMOTORS AND DRIVES	DRAWN PG 2/23/04
		CHK
		APPD
	TITLE EXTERNAL WIRING DIAGRAM TYPE "K" W/PROTECTOR	SCALE 1=1
	MAT'L. SINGLE VOLTAGE - DUAL ROTATION	REF 005326-01
FINISH		FMF 101405.00
		PREV

THIS DRAWING IN DESIGN AND DETAIL IS OUR PROPERTY AND MUST NOT BE USED EXCEPT IN CONNECTION WITH OUR WORK ALL RIGHTS OF DESIGN AND INVENTION ARE RESERVED THIS IS AN ELECTRONICALLY GENERATED DOCUMENT - DO NOT SCALE THIS PRINT		RFP	CAD FILE	00532602	SIZE	DRAWING NO.	REV.
		DIST			A	005326-02	

ERROR: undefined
OFFENDING COMMAND: de

STACK:

```
{/@FL --where-- --not-- {--pop-- --end-- --end-- }{--pop-- }--ifelse-- }  
/suspend  
-dictionary-  
/Pscript_WinNT_Compat  
-dictionary-
```



CERTIFICATION DATA SHEET

**1051 CHEYENNE AVE.
GRAFTON, WI 53024
PH. 262-377-8810**

CONN. DIAGRAM: 005326.02

CATALOG #: 101405.00

OUTLINE: 031760-600

MOUNTING: F1 ONLY

WINDING #: BE48470 1 A

TYPICAL MOTOR PERFORMANCE DATA

HP	kW	SYNC. RPM	F.L. RPM	FRAME	ENCLOSURE	KVA CODE	DESIGN
1/3	0.25	1800	1725	48	DP	K	NO DESIGN CODE

PH	Hz	VOLTS	AMPS	START TYPE	DUTY	INSL	S.F.	AMB°C
1	60	115	3.2	ACROSS THE LINE	CONTINUOUS	F3	1.35	40

FULL LOAD EFF:	75	3/4 LOAD EFF:	71.6	1/2 LOAD EFF:	63.3	GTD. EFF		ELEC. TYPE	
FULL LOAD PF:	94	3/4 LOAD PF:	93.4	1/2 LOAD PF:	90.2	70		CAP START CAP RUN	

F.L. TORQUE	LOCKED ROTOR AMPS	L.R. TORQUE	B.D. TORQUE	F.L. RISE°C
16.04 OZ-FT	27.1	21.7 OZ-FT 136 %	37.3 OZ-FT 233 %	25

SOUND PRESSURE @ 3 FT.	SOUND POWER	ROTOR WK^2	MAX. WK^2	SAFE STALL TIME	STARTS / HOUR	APPROX. MOTOR WGT
0 dBA	10 dBA	-1 LB-FT^2	0 LB-FT^2	10 SEC.	0	22 LBS.

***** SUPPLEMENTAL INFORMATION *****

DE BRACKET TYPE	ODE BRACKET TYPE	MOUNT TYPE	ORIENTATION	SEVERE DUTY	HAZARDOUS LOCATION	DRIP COVER	SCREENS	PAINT
STANDARD	STANDARD	RESILIENT BASE	HORIZONTAL	FALSE	NONE	FALSE	NONE	GREEN - LEESON WATTS AVER

BEARINGS		GREASE	SHAFT TYPE	SPECIAL DE	SPECIAL ODE	SHAFT MATERIAL	FRAME MATERIAL
DE	ODE						
BALL 6203	BALL 6203	POLYREX EM	STANDARD 48	NONE	NONE	1144 STRESSPROOF (C-223)	ROLLED STEEL

THERMO-PROTECTORS				THERMISTORS	CONTROL	SPACE HEATERS
THERMOSTATS	PROTECTORS	WDG RTDs	BRG RTDs			
NONE	AUTOMATIC	NONE	NONE	NONE	FALSE	NONE VOLTS

*
N
O
T
E

INVERTER TORQUE: NONE
INV. HP SPEED RANGE: NONE
ENCODER: NONE
NONE NONE
NONE NONE PPR
BRAKE: NONE NONE
NONE P/N NONE
NONE NONE
NONE FT-LB NONE V NONE HZ



LEESON ELECTRIC CORPORATION
 TYPICAL PERFORMANCE CURVE for AC MOTOR

Curve at 115 Volts HP 0.33 PHASE 1
60 HZ
0.33 HP VOLTS 115

Model No 101405.00

Catalog No 101405.00

HZ 60

RPM 1725

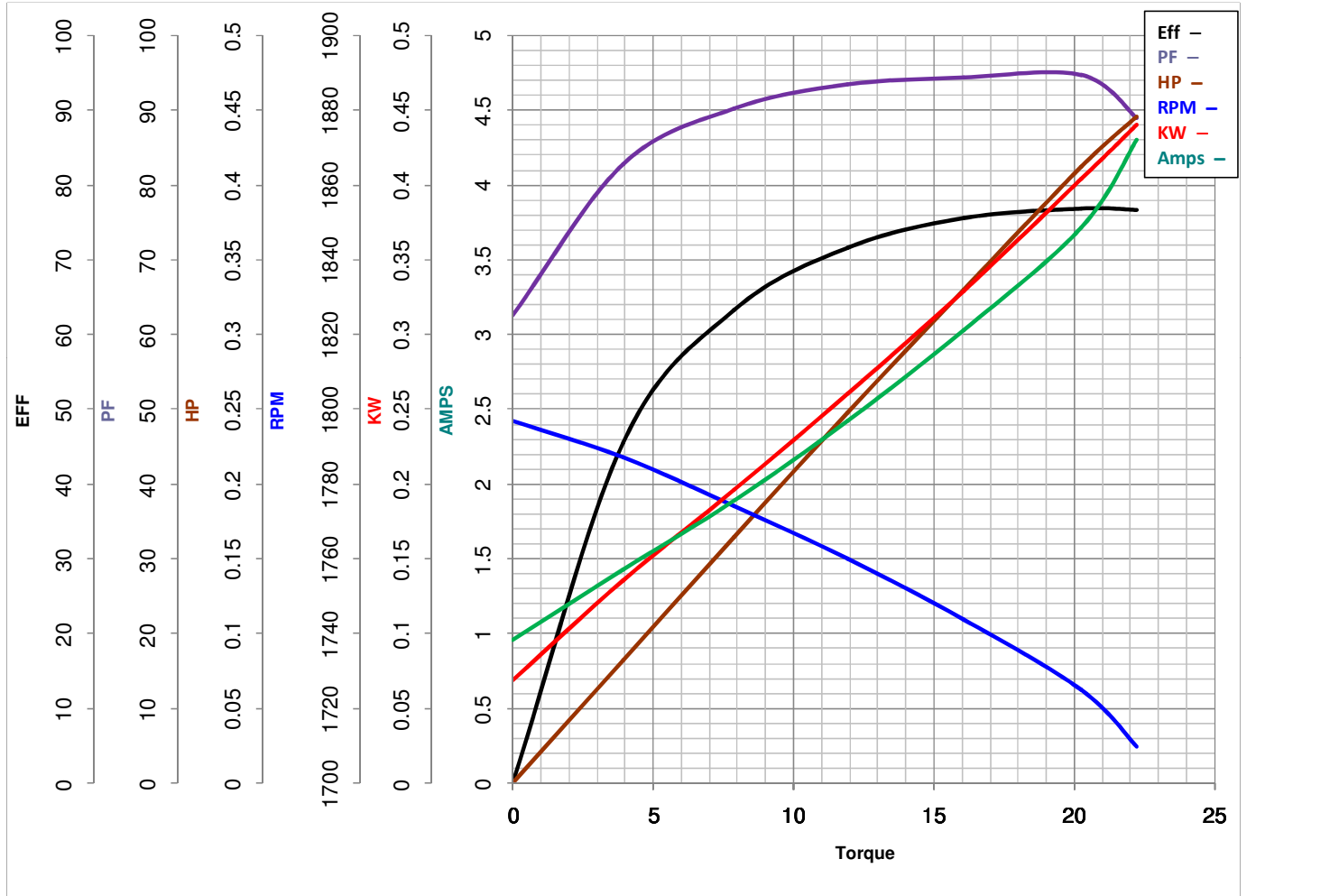

Torque in Oz.Ft

FL TORQUE 16.04 Oz.Ft
 BD TORQUE 37.3 Oz.Ft
 LR TORQUE 21.7 Oz.Ft

FL AMPS 3.2
 PU TORQUE 17.4 Oz.Ft
 LR AMPS 27.1

WINDING BE48470-1

Date 4/19/2018