

# PRODUCT INFORMATION PACKET

**marathon**<sup>®</sup>  
Motors

Model No: 5KCR48WN0273X  
Catalog No: G1377  
1 1/2, 1725, TEFC, 56H, 1/60/115/208-230  
Totally Enclosed Fan Cooled (TEFC)



Regal and Marathon are trademarks of Regal Beloit Corporation or one of its affiliated companies.  
©2018 Regal Beloit Corporation, All Rights Reserved. MC017097E

**REGAL**<sup>®</sup>

**Product Information Packet: Model No: 5KCR48WN0273X, Catalog No:G1377 1 1/2,1725,TEFC,56H,1/60/115/208-230**

**Nameplate Specifications**

Output HP	<b>1.5 Hp</b>	Output KW	<b>1.1 kW</b>
Frequency	<b>60 Hz</b>	Voltage	<b>115/208-230 V</b>
Current	<b>14.5,7.1-7.3 A</b>	Speed	<b>1725 rpm</b>
Service Factor	<b>1.15</b>	Phase	<b>1</b>
Efficiency	<b>73.6 %</b>	Duty	<b>Continuous</b>
Insulation Class	<b>B</b>	KVA Code	<b>K</b>
Frame	<b>56H</b>	Enclosure	<b>Totally Enclosed Fan Cooled</b>
Overload Protector	<b>AUTO</b>	Ambient Temperature	<b>40 °C</b>
Drive End Bearing Size	<b>6205</b>	Opp Drive End Bearing Size	<b>6203</b>
UL	<b>Recognized</b>	CSA	<b>Yes</b>
CE	<b>N</b>		

**Technical Specifications**

Electrical Type	<b>Capacitor Start Capacitor Run</b>	Starting Method	<b>SM</b>
Poles	<b>4</b>	Rotation	<b>Counterclockwise/Clockwise</b>
Mounting	<b>Rigid Base</b>	Motor Orientation	<b>ANY</b>
Drive End Bearing	<b>BALL</b>	Opp Drive End Bearing	<b>BALL</b>
Frame Material	<b>Rolled Steel</b>	Overall Length	<b>13.84 in</b>
Frame Length	<b>8.43 in</b>	Shaft Diameter	<b>0.63 in</b>
Shaft Extension	<b>1.88 in</b>		
Outline Drawing	<b>52A107633P4</b>	Connection Diagram	<b>52A110583AE</b>

**This is an uncontrolled document once printed or downloaded and is subject to change without notice. Date Created: 10/08/2018**

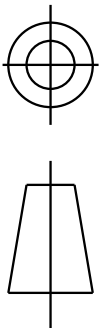

REV. 13

DESCRIPTION  
UPDATED PER ISO7-1173

DATE  
06/15/07

APPROVED  
MADHU

52A107633 13

DRAWING NO. A

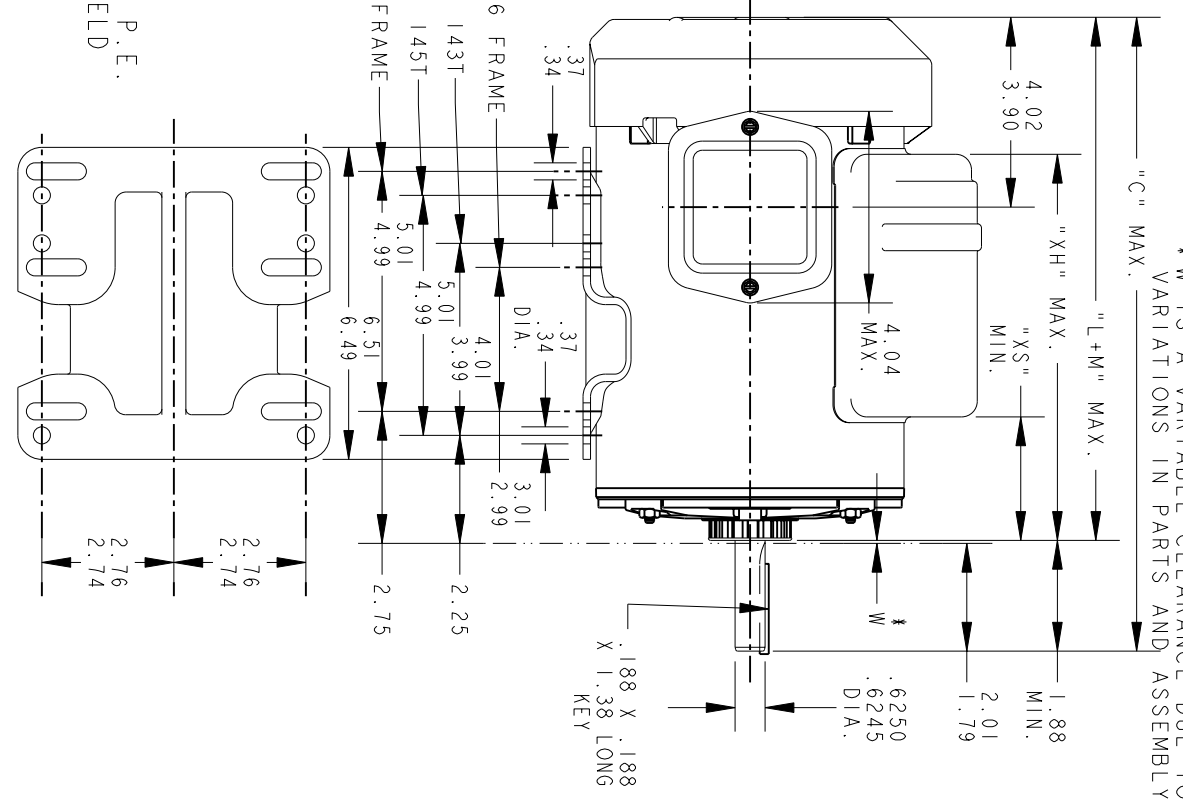
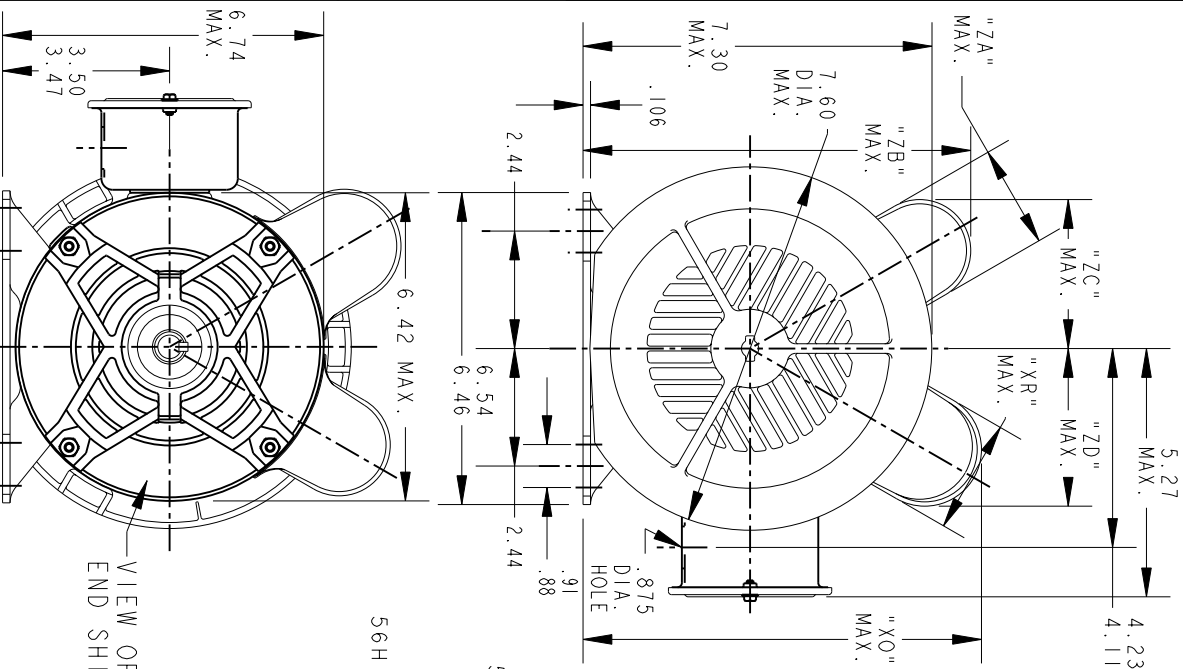

VIEW OF P.E.  
END SHIELD

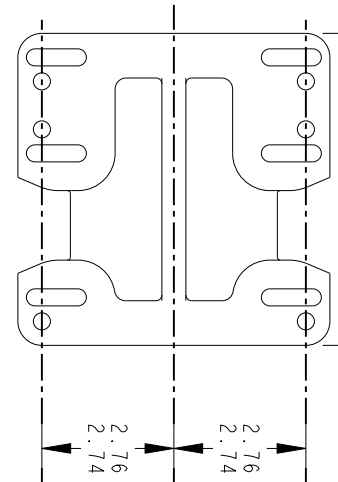

P	TYPE	FR SIZE	NEMA FR.	"C"	"L+M"	"XH"	"ZO"	"XR"	"XS"	"ZA"	"ZB"	"ZC"	"ZD"	MIN. SHELL
1	KCR	49	56H	12.96	11.07	8.22	8.40	2.40	2.47	2.15	8.15	3.20	3.38	7.68
2	KCR	49	56H	14.27	12.38	8.32	8.40	2.40	2.57	2.15	8.15	3.20	3.38	8.99
3	KCR	49	56H	14.27	12.38	8.32	8.77	2.72	2.57	2.15	8.15	3.20	3.66	8.99
4	KCR	48	56H	13.82	11.82	7.72	8.77	2.72	2.03	2.10	8.15	3.14	3.63	8.43
5	KCR	48	56	13.82	11.82	7.72	8.15	2.10	2.03	1.60	7.71	3.14	3.63	8.43

**REGAL-BELOIT CORPORATION**

TITLE  
**OUTLINE**

**GENERAL PURPOSE MOTOR - TEFC - BALL BEARING - WELDED BASE**

FOR ADDITIONAL INFO REFER TO:	MFG	ENGRG	CHECKED	DETAIL	MODEL	M.D. PAPER	DATE
APPLIED PRACTICES	QUALITY						
DIMENSIONS ARE IN INCHES	ISSUED					M.D. PAPER	04/12/94
MATERIAL	SOLID MODEL: 52A107633						

SCALE: 1.000 REF. No.:  
SIZE DRAWING A  
REV 13  
SHEET 1 of 1

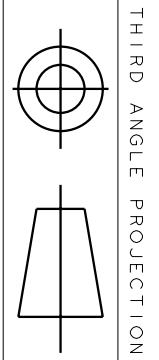

THIRD ANGLE PROJECTION

REV.	DESCRIPTION	DATE	APPROVED

CW ROTATION SHAFT END - DUAL VOLTAGE  
TYPE CAP START WITH THERMAL PROTECTOR

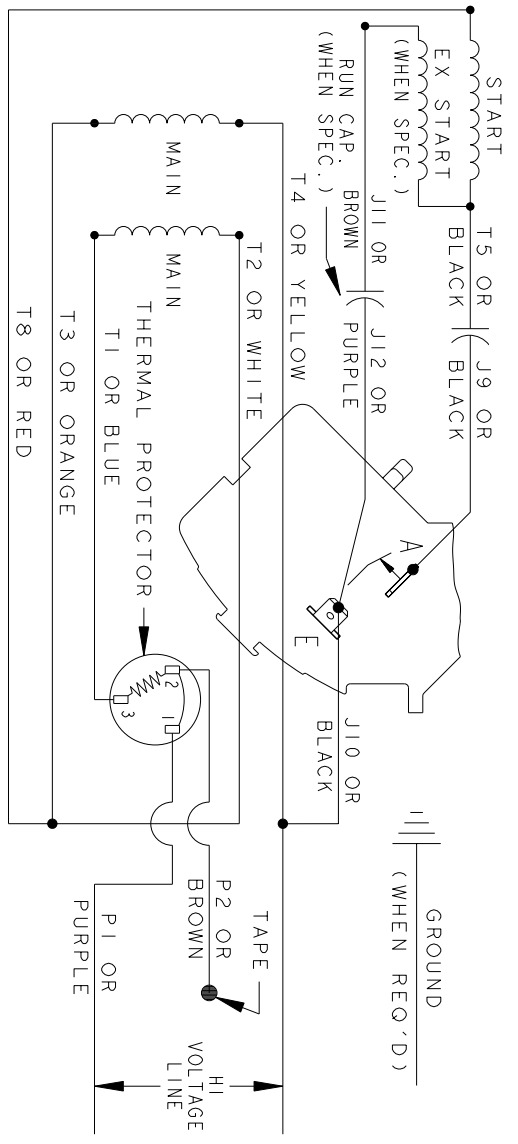
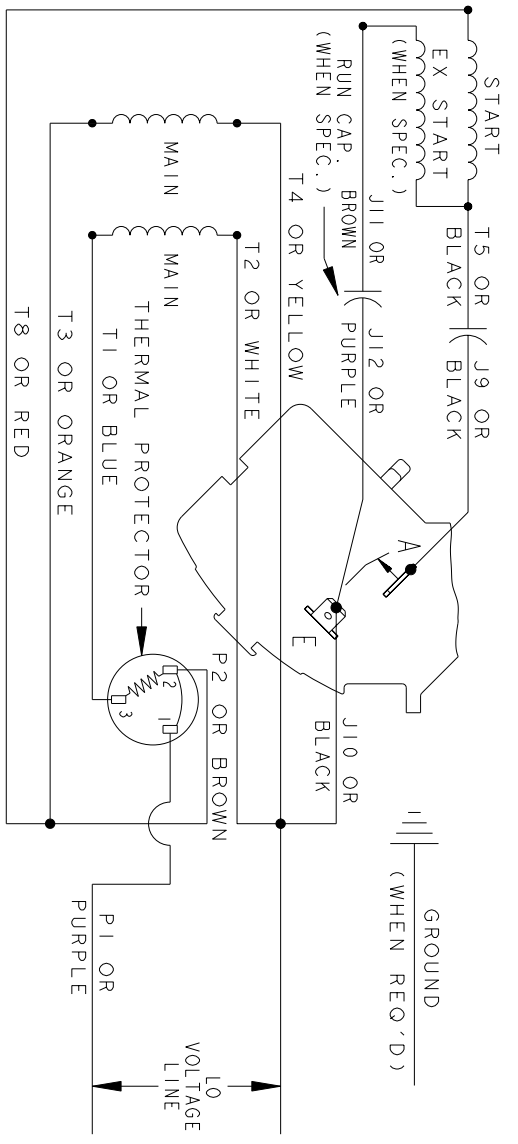

NOTE#1 - TO REVERSE ROTATION, INTERCHANGE T8 RED AND J10 BLACK LEADS  
NOTE#2 - WHEN MORE THAN ONE CAPACITOR IS USED, CONNECT IN PARALLEL.  
NOTE#3 - 115D958ABP5 - HIGH CURRENT CONTACTS.

REF. - 52A105383BA  
SWITCH - 115D958AB  
CONNECTION LABEL - 52X332912



REGAL-BELOIT CORPORATION

TITLE CONNECTION DIAGRAM

SIGNATURES	DATE
MODEL MADHU	10/29/09
DETAIL	.
CHECKED	.
ENGRG	.
MFG	.
QUALITY	.
ISSUED	MADHU 10/29/09
FOR ADDITIONAL INFO REFER TO:	
APPLIED PRACTICES	
DIMENSIONS ARE IN INCHES	
MATERIAL	SOLID MODEL: 52A110583AE

SIZE A	DRAWING	SCALE: 1.000	REF. No.:	SHEET 1 of 1
52A110583AE		REV 0		